

SAP no. 962163B

### Charging



→ ON



→ OFF

2 sec

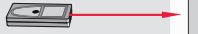

2 sec



min

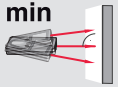

max

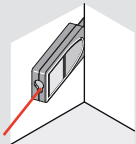
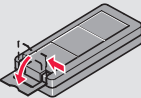
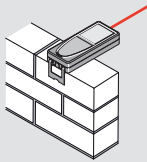
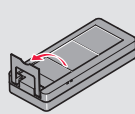

- 1 Status bar/ Function name
- 2 Haircross for aiming
- 3 Main line (result)
- 4 Active function
- 5 Selection keys linked to the symbol above
- 6 ON/DIST
- 7 Clear/OFF
- 8 Navigation
- 9 Add
- 10 Reference
- 11 Functions/ Settings screen
- 12 Zoom
- 13 Subtract
- 14 Equal/Confirm



Reference

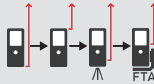

DST 360-X (optional)



## Quick Start Leica DISTO™ X6

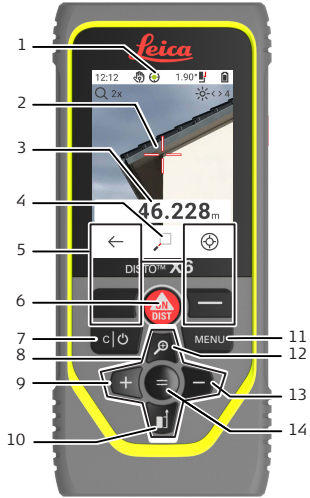

## MENU Functions



MENU → 1 × click



	Single distance measurement
	Area
	Volume
	Triangle area
	Smart horizontal mode
	Level
	Stake-out
	Timer
	Height tracking
	Reports viewer
	Slope
	Height profile
	Measure in picture - width
	Measure in picture - diameter
	Measure in picture - area
	Point-to-Point distance*
	Point-to-Point distance levelled*
	Point-to-Line distance*
	Smart area measurement*

	CAD data capturing*
	CAD project manager

\* Requires DST 360-X adapter

## MENU Settings



MENU → 2 × click

	Tilt units
	Distance units
	Screen rotation
	Beep
	Bluetooth
	Bluetooth settings
	Display illumination
	Favorites
	Keypad lock
	Tilt calibration
	Information/Serial number
	Distance offset
	Reset device
	Date/Time
	Gesture control
	Language
	Shutdown time
	Touchscreen
	Pointfinder

## Pointfinder On/Off



## Zoom

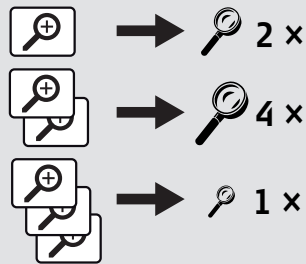

## Pointfinder Brightness

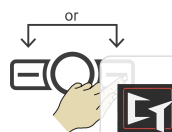

## Status Bar

12:22 5.30°

12:22	Time
	Gesture control
	Bluetooth® active
	Levelling status
	Measuring reference
5.30°	Inclination
	Distance offset set
	Battery status

## User Interactions



	Measuring indication		Bluetooth® navigation On/Off
	Confirm		Help
	Back		Delete
	Repeat		Navigation, confirm with equal key
	Save file*		Set back to 0 (Offset, Stake-out)
	Start levelling		
	Bluetooth* send		